

technical specs

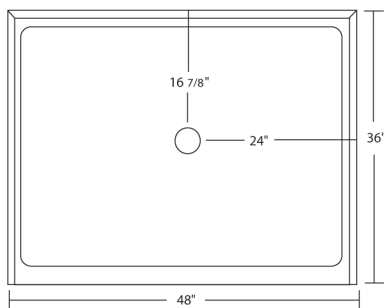

36" x 48" Shower Base

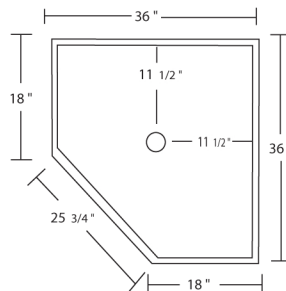

36" Neo Angle Base

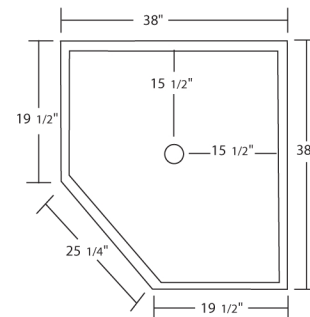

38" Neo Angle Base

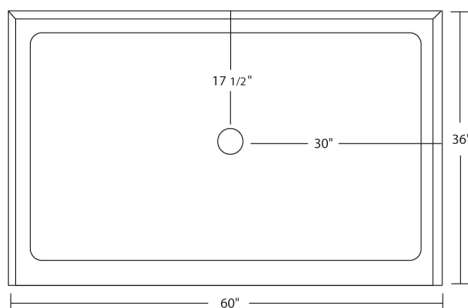

36" x 60" Shower Base

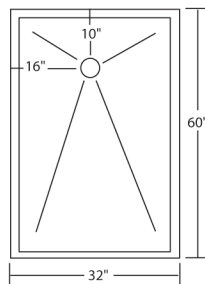

32" x 60" Shower Base

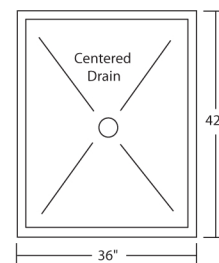

36" x 42" Shower Base

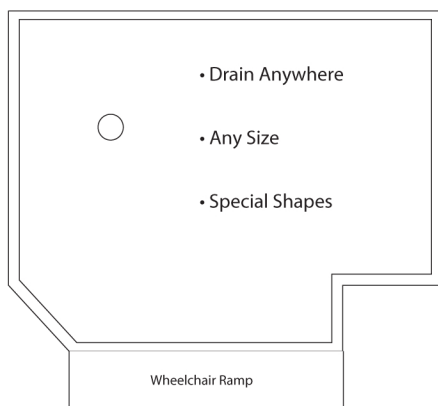

Custom Shower

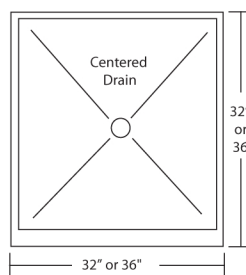

Square Shower Base

Shower & Tub Surrounds

We produce custom sizes and colors and can make panels out of all our standard materials. Marbletec is especially suited to surrounds and is lighter and easier to install than cultured stone. It can also save you money over other options.

•Handicap/Wheelchair accessible bases also available.
Custom shower bases are available in any size or shape you desire.
Bring in your plans and let us help make your unique designs come to life.